

**SECTION 00 91 13**

**ADDENDUM NO. 2**

**FEBRUARY 22, 2024**

**PROJECT:** Renovations & HVAC Upgrades to  
Holliman Elementary School  
70 Deborah Road, Warwick, RI 02888

- This addendum forms a part of the Contract Documents and modifies the original Bidding Documents dated January 2, 2024 as noted below.
- Please advise all sub-contractors.
- Acknowledge receipt of this Addendum in the space provided on the Bid Form.

**GENERAL**

- A. The following are questions submitted by Bidders to the Owner and their subsequent answers are highlighted in red.
1. Question: Please clarify the Base Bid vs Alternate #2 painting scope of work. For example; Refer to A1.2/detail 1. Demolition detail indicates that there are removals at all four elevations of a typical classroom. Per General Demolition Notes #7, GC is responsible to "patch and re-finish any surface where existing items or devices are removed" and per Note 12 on G1.1 GC would need to paint entire wall "from perpendicular wall to perpendicular wall". Therefore it appears that a Typical Classroom should be in base bid yet plan ALT2 indicates they are part of Alternate #2 scope. Please clarify.  
**Response: See note for Drawing G1.1 below that changes the Base Bid painting at removed items to a patch and touch-up paint. The Base Bid does not include painting the entire wall.**
  2. Question: Specification Section 01 81 22, Paragraph 3.09; Specification calls for a "Building flush out". Please clarify requirements to achieve this goal. I.E.; can new equipment be used to accomplish this, is there a level of "contaminant concentrations" that needs to be achieved, etc.  
**Response: New and existing equipment can be used for the flush out. There is no level of contaminant required to be achieved. A simple exchange of air with fresh outside air is to be undertaken.**

**PROJECT MANUAL**

**GENERAL**

**ITEM NO. 1 – PRE-BID CONFERENCE SIGN-IN SHEET**

- A. Attached to this Addendum is the Pre-Bid Conference Sign-in Sheet.

**ITEM NO. 1 – REVISED SPECIFICATION SECTIONS**

- A. 23 00 00.2.22.B.2 Delete the following text from the end of sub paragraph: (Add Addendum #3).
- B. 23 00 00.2.22.E.2.d Delete the following text from the end of sub paragraph: (Add Addendum #3).
- C. 23 00 00.2.22.E.7.d Delete the following text from the end of sub paragraph: (Add Addendum #3).
- D. 23 00 00.2.22.I Delete the following text from the end of sub paragraph: (Add Addendum #3).

**DRAWINGS**

**GENERAL**

**ITEM NO. 1 – REVISED DRAWINGS**

- A. Remove the following drawings and replace with revised drawings attached to this Addendum.  
AD1.1

**DRAWINGS**

**GENERAL**

**ITEM NO. 1 – DRAWING G1.1**

- A. General Note No.12:  
Delete the following two sentences:  
“ PAINT THE ENTIRE CEILING OR WALL IN A ROOM OR AREA, FROM PERPENDICULAR WALL TO PERPENDICULAR WALL. AT NEW ACOUSTICAL CEILING SYSTEM, PAINT TO SIX INCHES ABOVE ACT CEILING SYSTEM.”  
Replace with the following note:  
“TOUCH-UP THE PAINT WHERE A NEW PATCH IS INSTALLED AS REQUIRED TO MATCH THE EXISTING. THE ENTIRE WALL DOES NOT NEED TO BE PAINTED.”

NOTE: Painting of the entire wall is to be included in Alternate No. 2.

- B. General Note No.40: Clarification: add the following: “...Provide emergency escape and rescue window at locations with a lower case “e” symbol. See Floor Plan 1/A1.1 and Exterior Elevations on A2.1 and A.2...”
- C. General Note No.46: Delete the following: “...EQUAL TO SAKRETE SURFACE BONDING CEMENT...”; Add the following: “...Provide, at angled masonry window sills and angled precast concrete window sills, cementitious formed level surface prior to the window sub-sill install. Provide for parging and forming, equal to, Sikaquick-VOH cement and Sikadur-32-HI-MOD primer. Remove loose materials and dirt. Apply cement while primer is wet / tacky...”

- D. General Note No.50: Clarification: add the following: "...Reinstall existing electrical, fire alarm, and security equipment to the new window and door frames, unless noted otherwise. Verify the security equipment with the owner prior to construction. Coordinate and reinstall the maximum quantity possible of conduits and frame mounted equipment above the new ceiling systems..."
- E. General Demolition Note No.23: Clarification: add the following: "...GC is responsible to record the location of existing systems fastened to door and window frames including electrical, fire alarm, and security equipment. To be reinstalled in the new work. Verify security with the owner prior to construction..."
- F. General Demolition Note No.24: Clarification: add the following: "...Remove and Dispose existing electronic latch systems, unless noted otherwise..."
- G. General Demolition Note No.25: Clarification: add the following: "...Remove and Dispose existing roller shades fastened to the window systems..."

ITEM NO. 2 – DRAWING AD1.1

- A. Demolition work key note: Add the following notes to resource room 120:  
16. See note on A1.13 for removal of perforated ceiling / wall tiles

ITEM NO. 3 – DRAWING A1.5

- A. Exterior door in classroom 14 – remove 'ETR' and add note "See notes on AD1.1 & A1.1"

ITEM NO. 4 – DRAWING A1.6

- A. Exterior door in classroom 14 – remove 'ETR' and add note "See notes on AD1.1 & A1.1"

ITEM NO. 5 – DRAWING A1.7

- A. Elevation 'A' add section mark 1/A1.16 thru sink.
- B. Elevation 'A' add section mark 2/A1.16 thru cabinet adjustment to sink.
- C. Elevation 'D' remove 'ETR' and add note "See notes on AD1.1 & A1.1"

ITEM NO. 6 – DRAWING A1.8

- A. 1/A1.8 remove dashed line to left of classroom entry door. VCB is to remain.
- B. Exterior door in classroom 12 – remove 'ETR' and add note "See notes on AD1.1 & A1.1".

ITEM NO. 7 – DRAWING A1.9

- A. 1/A1.9 remove 'ETR VCB' note from south wall.
- B. 1/A1.9 add note pointing to south wall "New VCB on entire wall to match existing".
- C. Add general note "Patch area of removed concrete pad with new VCT to match existing. Install full tiles only".

ITEM NO. 8 – DRAWING A1.11

- A. Add note to details 5 & 6 “Remove and patch VCT & VCB as required”.

ITEM NO. 9 – DRAWING A1.17

- A. Detail 4/A1.17 remove ‘classrooms 1-3’ from note “core holes in top panel...”.

ITEM NO. 10 – DRAWING AD2.2

- B. 4/AD2.2 Elevation-HH-DEMO: Clarification: add the following: Add demolition work key note-14 to the windows adjacent to doors C5 and C6.

ITEM NO. 11 – DRAWING AD3.1

- A. 5/AD3.1 Demo View: Exist Door E1,Typical: Clarification: add the following note: “...Remove & Dispose existing electronic door latch equipment at doors receiving new electronic latches...”

ITEM NO. 12 – DRAWING A3.1

- A. 1/A3.1 Window Types: Clarification: add the following: At window type-F provide detail 4/A3.4 at locations with designation “MW”.

ITEM NO. 13 – DRAWING A3.2

- A. 1/A3.2 Window Types: Add the following: At window type-M1 provide sill detail like drawing A1.1 Keyed Work Note-14 and detail 6/A1.11.
- B. 1/A3.2 Window Types: Clarification: add the following: At window type-Q2 provide detail 6/A3.4 at locations with designation “MW”.

ITEM NO. 14 – DRAWING A3.3

- A. 1/A3.3 Section: Window Sill Type-E,Typ: Add the following note: “...Provide cementitious formed level surface prior to sub-sill install equal to Sikaquick-VOH cement & Sikadur-32-Hi-Mod...”
- B. 2/A3.3 Section: Window Sill Type-Q,Typ: Add the following note: “ At window type-C, K, L, M, Q, Provide cementitious parge system at removed wood window frames prior to sub-sill install equal to Sikaquick-VOH & Sikadur-32-Hi-Mod...”
- C. 3/A3.3 Section: Win Type-F Sill,Typ: Add the following note: “...Provide cementitious formed level surface prior to sub-sill install equal to Sikaquick-VOH cement & Sikadur-32-Hi-Mod...”
- D. 3/A3.3 Section: Win Type-F Sill,Typ: Add the following note: “...Provide sill detail like drawing A1.1 Keyed Work Note-14 and detail 6/A1.11, apron to cover existing sill blocking...”

ITEM NO. 15 – DRAWING A5.0

- A. Under notes – change ACT-2 to read “To be located in the Library, Resource 120, Classrooms 1-10 and 15-19, Speech 106, Reading 107 and Math 108. See specs”.
- B. ACT soffit note in library to read “ACT soffit - see sim detail 2/A.5.0. Coordinate size with equipment.”
- C. Remove words ‘Add Alternate #1’ from All-purpose room.

ITEM NO. 16 – DRAWING A6.1

- A. 1/A6.1 Roof Repair Plan: Add the following note: “...Provide at new thru roof condensate pipes (CP) Roof Keyed Work Note-3 new roof deck opening...”
- B. 1/A6.1 Roof Repair Plan: Add the following note: “...Provide at Roof-1B two additional Roof Keyed Work Note-3 roof deck opening and 7 curb flashing...”
- C. 1/A6.1 Roof Repair Plan: Add the following note: “...Provide at Roof-2A two additional Roof Keyed Work Note-4 pipe flashing at condensate pipe...”

ITEM NO. 17 – DRAWING A6.2

- A. 1/A6.2 Sect: Pedestal EQP Support Flashing, Typ: Clarification: Add the following note: “...Provide 1’-0” minimum from roof surface to membrane termination under sheet metal cap flashing. See detail 6/M6.2 Duct Support and 1&3/S2.1 for wood blocking sleeper fastened to the roof deck...”
- B. 1/A6.2 Sect: Sleeper EQP Support Flashing, Typ: Clarification: Delete the sheet metal cap and continuous cleat. Add the following note: “...Provide roof membrane termination like detail 9/A6.2. See detail 6/M6.3 for Greenheck GESI equipment support and details 1&3/S2.1 for wood blocking sleeper fastened to the roof deck...”

ITEM NO. 18 – DRAWING A7.1

- A. Exterior Door and Frame Schedule: Clarification: Add the following note to the Door Schedule General Notes: “...14. See detail 1/A7.1 Frame Types for detail markers...”
- B. Exterior Door and Frame Schedule: Clarification: “...Delete, at frame glass column, tempered glass and provide opaque metal panels 1 inch thick
- C. Exterior Door and Frame Schedule: Clarification: “...Door-C9 add Door Schedule Remark 3-Electric Latch...”
- D. Exterior Door and Frame Schedule: Clarification: “...Door-D14 revise door pair width to 5’-1”, revise frame width to 5’-5” ...”
- E. 1/A7.1 Door and Frame Types: Clarification: Frame type-7 delete jamb detail 1&2/A7.2. Add jamb details 6&7/A7.2. Reduce the door and frame width by seven inches.

ITEM NO. 19 – DRAWING A7.2

- A. 1/A7.2 Plan Detail: Door-A1 Jamb 1'-0" AFF, Typ: Clarification: Add the following note to the steel angle shown at 3 ½" by 5 ¼" engineered column: "...Provide at top and bottom galvanized steel angle, anchor post to concrete floor slab and roof deck, equal to Strong-tie HL33-HDG, Typical..."

ITEM NO.20 – DRAWING ALT2

- A. Note #9 to read "Prep , prime and paint walls around lockers in corridor C102. Lockers are to remain in place".

End of Addendum No. 2



**Bid #24-0007 Mandatory Pre-Bid Site Visit  
Project: Holliman Renovations and HVAC Upgrades**

Name	Company	Email	Cell or Contact #
------	---------	-------	-------------------

- |    |                    |                      |                                      |                |
|----|--------------------|----------------------|--------------------------------------|----------------|
| 1  | Matthew DePasquale | ADS construction     | Matt@adsconst.com                    | (401)447-1018  |
| 2  | DERRICK PAPA       | TOWER                | estimating@towerconstructioncorp.com | 401.943.0110   |
| 3  | Bob Dandeneau      | EW BURMAN INC        | estimating@ewburman.com              | 401 - 738-5400 |
| 4  | James Edwards      | JG Edwards Const     | jedwards@jedwardsconstruction.com    | 401-683-9110   |
| 5  | Bill Poole         | Eng. Weld + Fab.     | WJP4998@gmail.com                    | 401-641-8384   |
| 6  | DAVID HIPOLITO     | G&V                  | DHIPOLITO@GRIFFITHANDVARY.COM        | 508 415 2527   |
| 7  | XL CALCAGNO        | S&A                  | ALISA.ARCHITECTS.COM                 | (401)829-3286  |
| 8  | Jake Paulino       | Ahlberg Construction | jpaolino@ahlberg.com                 | (401) 528-9269 |
| 9  | Tom Mello          | MARON CONST          | TMELLO@MARONCO.COM                   | 401-272-4930   |
| 10 | Jessie Simas       | Ahlberg constructio  | jsimas@ahlberg.com                   | 401-658-6145   |

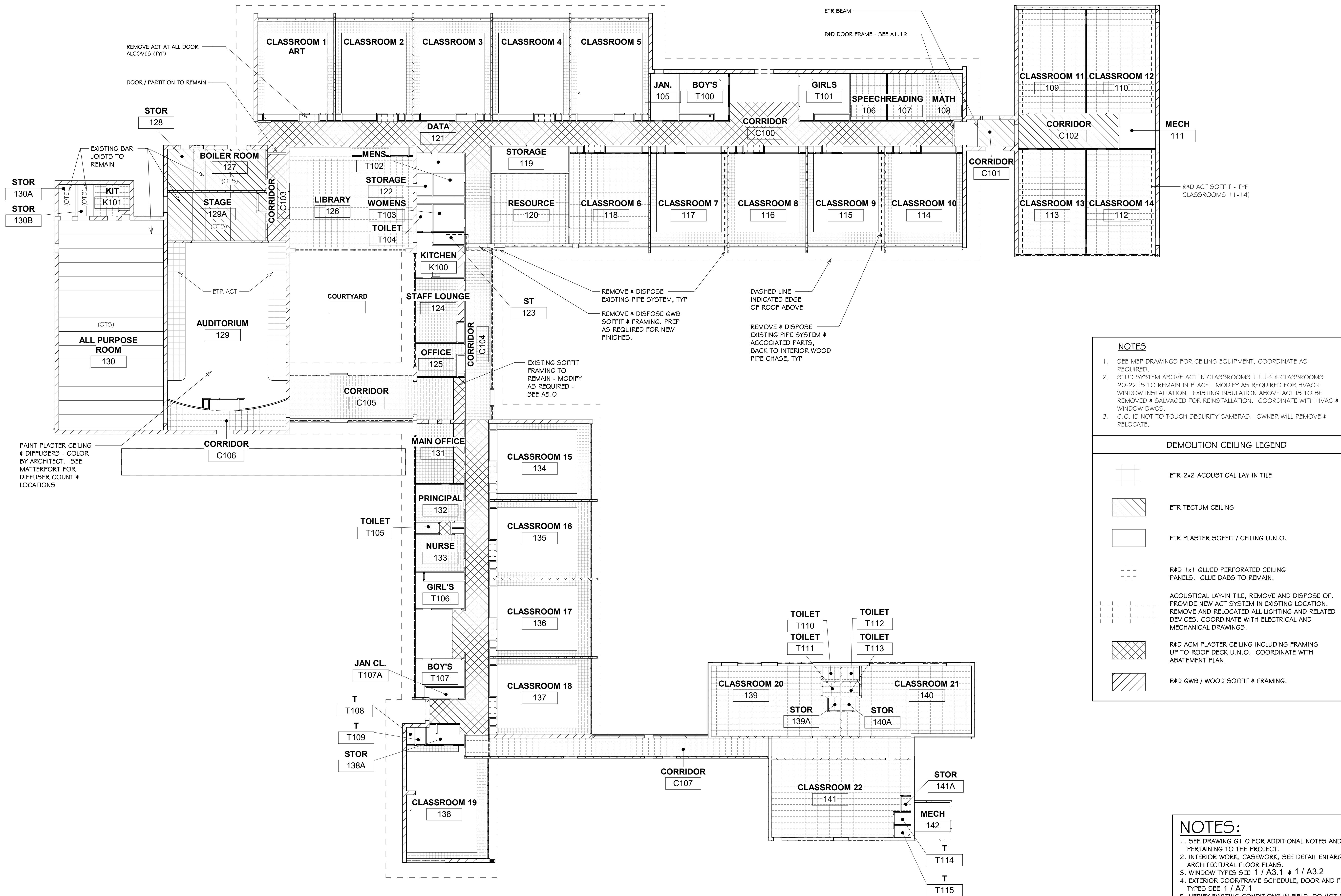

- NOTES**
- SEE MEP DRAWINGS FOR CEILING EQUIPMENT. COORDINATE AS REQUIRED.
  - STUD SYSTEM ABOVE ACT IN CLASSROOMS 11-14 & CLASSROOMS 20-22 IS TO REMAIN IN PLACE. MODIFY AS REQUIRED FOR HVAC & WINDOW INSTALLATION. EXISTING INSULATION ABOVE ACT IS TO BE REMOVED & SALVAGED FOR REINSTALLATION. COORDINATE WITH HVAC & WINDOW DWGS.
  - G.C. IS NOT TO TOUCH SECURITY CAMERAS. OWNER WILL REMOVE & RELOCATE.

**DEMOLITION CEILING LEGEND**

	ETR 2x2 ACOUSTICAL LAY-IN TILE
	ETR TECTUM CEILING
	ETR PLASTER SOFFIT / CEILING U.N.O.
	R4D 1x1 GLUED PERFORATED CEILING PANELS. GLUE DABS TO REMAIN.
	ACOUSTICAL LAY-IN TILE, REMOVE AND DISPOSE OF. PROVIDE NEW ACT SYSTEM IN EXISTING LOCATION. REMOVE AND RELOCATE ALL LIGHTING AND RELATED DEVICES. COORDINATE WITH ELECTRICAL AND MECHANICAL DRAWINGS.
	R4D ACM PLASTER CEILING INCLUDING FRAMING UP TO ROOF DECK U.N.O. COORDINATE WITH ABATEMENT PLAN.
	R4D GWB / WOOD SOFFIT & FRAMING.

- NOTES:**
- SEE DRAWING G1.0 FOR ADDITIONAL NOTES AND LEGENDS PERTAINING TO THE PROJECT.
  - INTERIOR WORK, CASEWORK, SEE DETAIL ENLARGED ARCHITECTURAL FLOOR PLANS.
  - WINDOW TYPES SEE 1 / A3.1 & 1 / A3.2
  - EXTERIOR DOOR/FRAME SCHEDULE, DOOR AND FRAME TYPES SEE 1 / A7.1
  - VERIFY EXISTING CONDITIONS IN FIELD. DO NOT DAMAGE OR CUT ANY STRUCTURAL ELEMENTS. IF CONDITIONS DIFFER TO WHAT IS SHOWN ON THESE DRAWINGS, NOTIFY ARCHITECT IMMEDIATELY PRIOR TO COMMENCING WORK.
  - COORDINATE ARCHITECTURAL AND CIVIL, STRUCTURAL, PLUMBING, MECHANICAL, AND ELECTRICAL WORK.
  - INFILL / PATCH EXISTING WALLS, CEILINGS, FLOORS TO REMAIN WHERE EQUIPMENT HAS BEEN REMOVED. PAINT/FINISH TO MATCH EXISTING. COORDINATE WITH MEP DWGS.
  - PROVIDE VCB AT BOTTOM OF ALL NEW BOOKCASES. COORDINATE WITH OWNER'S FF#E. COLOR BY ARCHITECT.

1  
AD1.2 1/16" = 1'-0"  
1st FLOOR REFLECTED CEILING PLAN - DEMOLITION

ISSUED FOR PERMIT AND CONSTRUCTION 01-02-2024



**Saccoccio & Associates, Inc.**  
1085 Park Avenue  
Cranston, Rhode Island 02910  
tel 401.942.7970  
fax 401.942.7975

Consultant

**RENOVATIONS & HVAC UPGRADES TO HOLLIMAN ELEMENTARY SCHOOL**

70 DEBORAH RD.  
WARWICK, RI

FOR  
WARWICK PUBLIC SCHOOLS

**Revision Schedule**

Revision Number	Revision Date

**SHEET TITLE  
DEMOLITION REFLECTED CEILING PLAN**

COPYRIGHT 2021  
THIS DRAWING IS THE PROPERTY OF SACCOCCIO AND ASSOCIATES ARCHITECTS. ANY USE OR REPRODUCTION WITHOUT THE EXPRESSED WRITTEN CONSENT FROM THE ARCHITECT IS PROHIBITED.

DRAWN BY: AW,KC JOB NUMBER: 23048A  
CHECKED BY: SG DATE: 01-02-2024

**AD1.2**

SHEET: OF: